



Scuba Cat Diving
M/V Scuba Cat
Phuket, Thailand



Similan Islands

The most comfortable and stable liveaboard in the Similan Islands



*Relaxation and Great Diving in the
Similan Islands*

M/V SCUBA CAT LIVEBOARD



Relaxation is an important factor on any liveboard. On Scuba Cat you will enjoy comfort and privacy in our twin cabins. On top of Scuba Cat you will find an 80 square meter sun deck. This is an ideal place for sun bathing, sleeping or romantic star watching at night. While on board you will have the opportunity to meet, enjoy and establish friendships with divers from all over the world. Scuba Cat's spacious saloon area is equipped with a TV, video, and stereo.

Scuba Cat is an ideal scuba diving platform. The designed in stability of a very large catamaran boat

operating amongst the protected waters of the Similans makes this the most "friendly" boat to be found-seasickness is rare. This truly is a boat for people who don't like boats and is an excellent choice for someone's first liveboard experience. With the efficiency of the operation and convenience of scuba diving we are able to offer up to five dives a day for those who wish. In keeping with our philosophy of a relaxed atmosphere, we are happy to drop guests of on the beach, provide ocean kayaks for your enjoyment as well as arrange our famous sunset volleyball game. Non-divers are most welcome and are sure to enjoy the variety of activities available.



Scuba Cat is without a doubt the most comfortable and stable diving platform touring the Similan Islands. Our scuba divers can gear up in spacious surroundings and enter the water six abreast. So the day is over and the sun is setting. Could it really be any better than this?



GO DIVING



GO to the Similans
with Scuba Cat Diving

Rates and Schedules



From November until beginning of May, Scuba Cat is based in the Similan Islands - Scuba Cat transfers you from your hotel in Phuket to the seaside resort of Tap Lamu, some 90 km north of Patong Beach. From here you board our transfer boat, MV Scuba Sport, which takes you out to Scuba Cat at the Similan Islands.

Scuba Cat transfers passengers to and from Scuba Cat every Monday, Wednesday, Friday and Sunday. This unique set up allows you to stay for as many days as you like!

Duration	Departure	Price	No of Dives
2 Days & 1 Night	Sunday	12,000 THB	6
3 Days & 2 Nights	Monday, Wednesday, Friday	16,000 THB	11
4 Days & 3 Nights	Sunday, Friday	20,000 THB	16
5 Days & 4 Nights	Monday, Wednesday	24,000 THB	21
Extra Day		5,000 THB	

Included in the price is:

Hotel transfers · Freshly cooked buffet meals · Snacks · Fruits · Coffee · Tea · Water · Towels · Tanks · Weights · Divemaster service · Dive torch



Note:

- Non-Divers receive 20% discount
- Snorkellers receive 20% discount
- Family room on request

Possibility to combine with M/V Scuba Adventure to Koh Bon, Koh Tachai, Richelieu Rock and Surin Islands

*One of the top 10 destinations in the world
Similan Islands*

Sample Itinerary

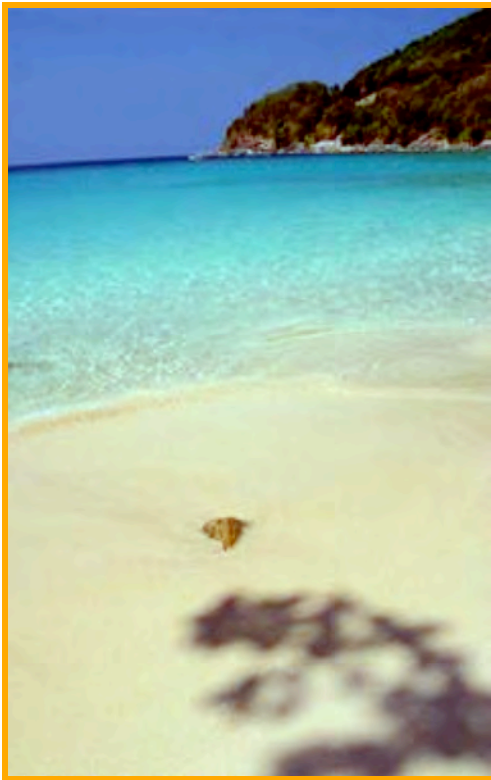

Day 1 – 3 dives

Pick up from Phuket hotels 06:30-07:00 and transfer to m/v Scuba Cat in the Similan Islands. Arrive at 12:30 and a hearty buffet lunch is waiting. After lunch there will be cabin assignments, a complete boat and dive safety and procedures briefing then time to gear up for your first dive and look underwater in the fabulous Similans. You are now in the Eat- Sleep- Dive routine of liveaboard diving. On m/v Scuba Cat we have 5 dives a day scheduled and are happy to take you to the beach on request. The dive sites in the Similans are often located fairly close together so it is possible to spend time onshore and get picked up for dinner a little later. We also have Ocean Kayaks onboard for your enjoyment.

After a light snack of fresh fruit and cookies is the second dive of the afternoon. Dinner is at 18:00 and is always enjoyable meeting new friends and sharing the day's diving experiences.

Full day (day two, three, four, five...) - 5 dives

Wake-up call at 06:30 with a light self-serve breakfast of toast, fruit, cereal, juice and coffee will get your day going.

First dive is at 07:30 and is followed by a full western style breakfast. Second dive is at 10:30. Lunch is at 12:00 with afternoon dives at 14:00 and 16:00.

Dinner at 18:00 followed by the night dive at 19:30. Trips to the islands, snorkeling, kayaking or just chilling out on the roof are always available for a bit of a change of pace.

EAT- SLEEP- DIVE!!



Departure Day - 3 dives

On your last day in the Similans we have dives scheduled at 07:30, 10:00 and 12:00. Lunch will be served at 13:00 with transfer back to Patong Beach at 14:15.

The cruise back to Patong will be a great chance to catch up with your logbook.

Dive sites

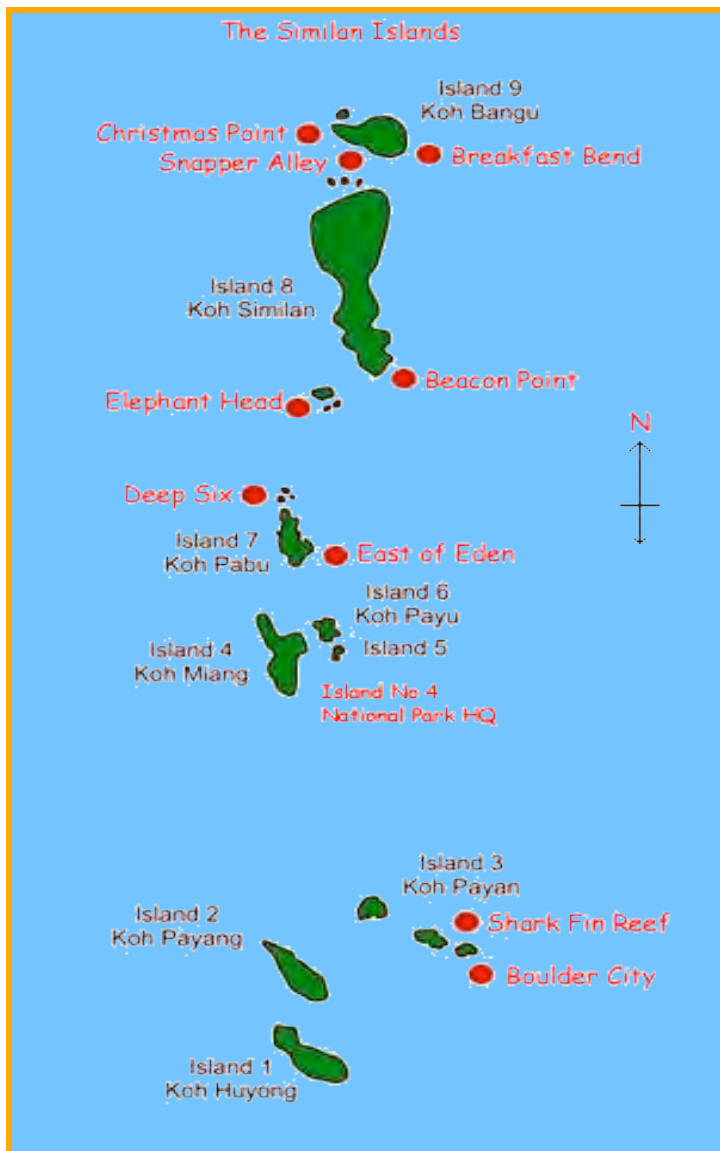

The Similan Islands

The Similan Islands are commonly rated as one of the top 10 dive destinations in the world. The islands are located 100 km (sixty miles) Northwest of Phuket and have been a Marine National Park since 1982. The Similans are comprised of 9 granite islands running north to south with numerous small rock outcroppings, white sand beaches and tropical jungle. Spectacular dive sites in warm, clear waters make this a diving paradise. The Similans provide a huge variety of diving topography and boast the richest variety and abundance of reef fish in Thailand.

A world of giant underwater boulders, caves, canyons, narrow passages, some 500 species of hard and soft corals and an amazing variety of marine life including leopard sharks, guitar rays, whale sharks, manta rays and turtles is waiting to be explored. Photographers take note that the Similan Islands are also well known for such photogenic critters as ghost pipefish, sea moths, frogfish, ribbon eels and nudibranches. Whatever your pleasure, the Similans will satisfy your desires and give you the diving trip of a lifetime.

These are some of the dive sites in the Similan Islands

Honeymoon Bay

Hideaway reef is a great place to check out dives or night dives. With depths along the reef at 20 meters this site has some spectacular coral bommies. Covered in soft corals the colors are superb and a great dive for macro photographers with harlequin and ornate ghost pipefish. Down in the sandy bottoms are fields of spotted garden eels poking their heads out to catch a passing feed. On the reef there are plenty of surges, butterfly and angelfish with blue fin travelies and goatfish on the hunt for small baitfish.





Boulder City

Boulder City lies some 200-meter south of Koh Payan. The dive site is completely submerged with two mooring buoys to mark the location, one at the north end and one at the south. Descending down the north line takes you to 20 meters and the south line to 30 meters. This is a dive in the 20 to 30 meter range with large granite boulders some bigger than a house, swim-troughs and the chance of swimming with large pelagics. Eagle and manta rays cruise around the large

pelagics. Eagle and manta rays cruise around the large boulders while blue spotted fantail rays rest in the sandy bottom. With a family of large humphead parrot fish and napoleon wrasse living in the area and the beautiful soft corals and large gorgonian sea fans make this an eye opening dive site with the occasional whale shark cruising past.

Honeymoon Bay

Honeymoon Bay is a beautiful bay on the backside of Island 4 with its quiet beach and tranquility is the perfect place for a snorkel or our sunset dives on the gentle sloping reef down to 24 meters. In the shallows around the coral heads you will find octopus, crabs and mantis shrimps on the hunt for food. The occasional hawksbill sea turtle and white tip reef shark patrolling the reef will keep you on the lookout during your dive.



Hideaway Reef



Hideaway reef is great place for check out dives or night dives. With depths along the reef at 20 meters this site has some spectacular coral bommies. Covered in soft corals the colors are superb and a great dive for macro photographers with harlequin and ornate ghost pipefish. Down in the sandy bottoms are fields of spotted garden eels poking their heads out to catch a passing feed. On the reef there are plenty of surgeons, butterfly and angelfish with blue fin travelies and goatfish on the hunt for small baitfish.

Similan Islands

Deep Six

Deep Six lies on the northern tip of Island 7 and has a buoy line running down to 18 meters there as the name implies you can descend down to over 60 meters. Here the dramatic underwater boulders have formed some excellent swim troughs, tunnels and canyons that make this an exciting dive. But down in the soft coral garden the largest gorgonian sea fans in the Similans survive untouched. Large barrel sponges add more to the "bigness" of this dive.



Elephant Head rock

Elephant Head (Hin Pousar in Thai)- This is probably the most famous dive site in the Similan Islands, located between Island 7 (Koh Payu) and Island 8 (Koh Similan).

With three large rocks breaking the surface these granite boulders run down to over 50 meters. This is dramatic dive. Not too much coral growth but the way the boulders are piled on top of each other has left an intricate web of tunnels and swim-troughs. Large overhangs with oriental sweetlips and harlequin sweetlips, which are only found in the Andaman Sea, hang around in small groups to escape the currents. Coming in and out of the tunnels keep an eye open for the colorful clown triggerfish and the white tip reef sharks resting on the bottom. Currents can be quite strong sometimes but this makes for an exciting and fun dive.

Beacon Point

Beacon Point lies on the south tip of island # 8 and is one of the deeper sites on the east side running down to 40 meters. This is a great spot to look for stingrays, including the small and common blue spots and mask rays to the larger black spotted fantails and Jenkins rays. With large granite boulders and the occasional White tip reef shark swimming round the boulders, try to see if you can spot the blue ribbon eels poking their heads out from their sandy holes.



Beacon Reef



Beacon Reef lies on the east side of the island and has the longest reef in the Similans This is a great check out or night dive as the gentle sloping reef runs down to around 22 meters. With lots of hard and soft corals the reef fish here are in abundance with the lionfish and moray eels hiding in the holes. A glance out in to the blue can prove rewarding with large dogtooth tuna and travelies darting in to the reef to feed on the small bait fish. This is also the location of the Atlantis Wreck resting on the sloping coral wall from 12-32 meters. The wreck is packed with fish life and makes for more great photography.

North Point



North Point lies on the north side of the Island #9 with a dramatic underwater scenery of large boulders with canyons and swim troughs. As you descend down the line past the friendly batfish and head through the tunnels, keep your eyes open for a pair of Napoleon wrasse. In between the large canyons grow large gorgonian sea fans with excellent soft corals hiding harlequin ghost pipefish but a look out into the blue can be rewarding with frequent visits from the graceful manta ray passing overhead.

Breakfast Bend

Breakfast Bend derives its name from the beautiful early morning light here, and the coral is still in great shape despite damage to the southern areas of Island 9 due to the Asian tsunami in 2004. There are larger but less frequent corals on the steep reef slope where plate corals dominate.

Orange jewel fairy basslets in staghorn coral at Breakfast Bend.

The easy paced nature of this dive means it's an obvious dive site for a checkout dive at the beginning of your Similans dive trip, and there are lots of sergeant majors darting around making it an ideal site for snorkellers.

The reef slope drops to 18 meters then steep banks descend further to 34 meters where you can see black-spot garden eels. In the shallows, leopard sharks are seen resting in the sand and often octopus may be found lurking in the vicinity.

At the southern most point of the dive the reef gives way to large boulder formations lying in deeper water. There are few corals here, but due to the stronger currents in this more exposed area, there is a good chance to see cobia and larger tuna species that frequent the Similan Islands in search of food. The rocks form several small swim-troughs and channels where you may be lucky to find resting white-tip reef sharks.



M/V Scuba Cat Technical Drawing

Scuba Cat Diving

M/V Scuba Cat

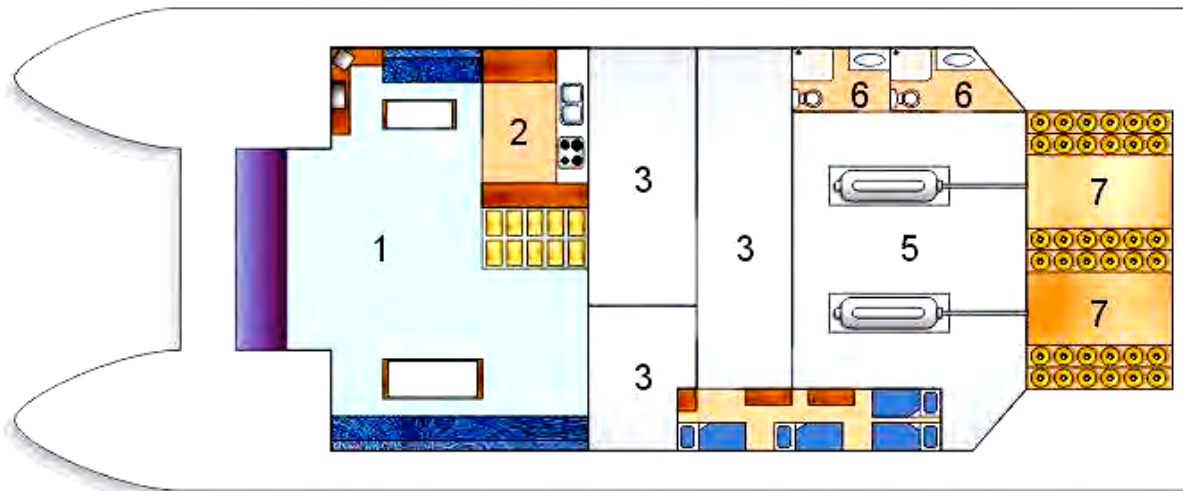

- | | | |
|----------------------|------------------------|--------------------|
| 1. Saloon | 4. Crew cabin | 7. Diving platform |
| 2. Galley | 5. Engine & compressor | 8. Guest cabin |
| 3. Storage equipment | 6. Shower/toilet | 9. Sun & Moon deck |

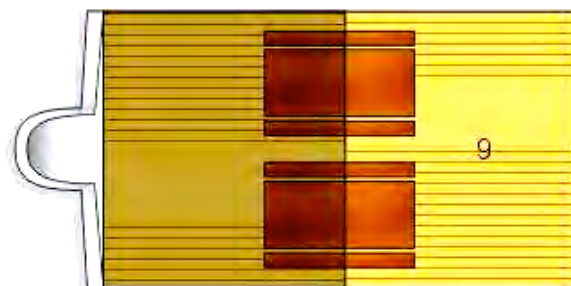
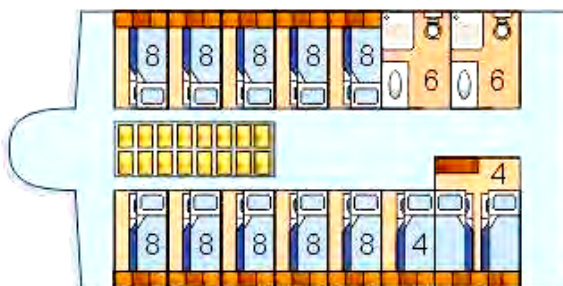

Contact Information

Sarah Kench, General Manager

Email: info@scubacat.com

Mobile (+66) 089 872 2026

skype: divethailand

Address:

**Scuba Cat Diving
94 Thaweewong RD
Patong Beach
83150 Khatu, Phuket
Thailand**



Booking Office Telephone: (+66) 76 293 120

Tel: 076 293 121 from Thailand or 66 76 293 121 from overseas

Fax: (+66) 76 293 122

www.scubacat.com

